

CARACTERÍSTICAS / FEATURES

Material SMC
Acabado liso
Dimensiones l. 80, a. 40, h. 40 cm.
Color ver carta de colores
Fijación simplemente apoyado
Peso / Capacidad 35 Kg / 93 L

Material SMC
Finish smooth
Dimensions l. 80, w. 40, h. 40 cm
Colour see colour catalogue
Fixing resting on the ground
Weight 35 Kg / 93 L

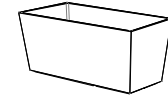

GEOMETRIA / GEOMETRY

ESPECIFICACIONES / SPECIFICATIONS

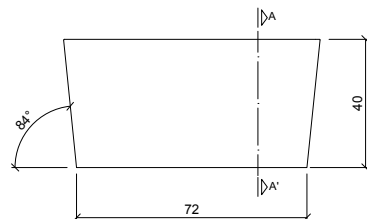

ALZADO / FRONT VIEW

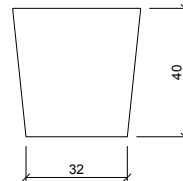

PERFIL / PROFIL VIEW

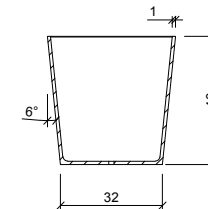

SECCIÓN A-A' / SECTION A-A'

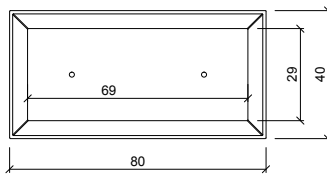

PLANTA / TOP VIEW

