

CARACTERÍSTICAS / FEATURES

Material hormigón Petra 1
Acabado decapado e hidrofugado
Dimensiones l. 90, a. 90, h. 80 cm
Color ver carta de colores
Fijación apoyado por su propio peso o mediante resina epoxi
Peso 400 Kg / 438 L
Palet 100 x 100 cm

Material precast concrete Petra 1
Finish scaled and waterproofed
Dimensions l. 90, w. 90, h. 80 cm
Colour see colour catalogue
Fixing resting on the ground or with epoxy resin
Weight 400 Kg / 438 L
Pallet 100 x 100 cm

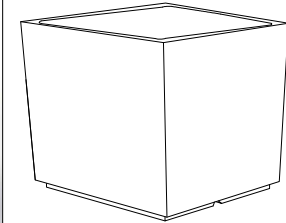
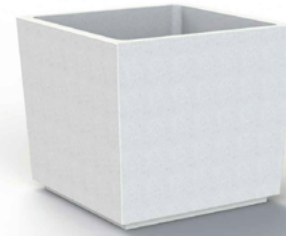

GEOMETRIA / GEOMETRY

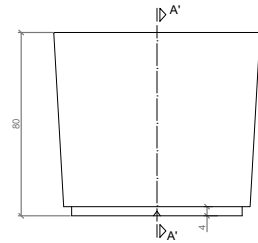

ALZADO / FRONT VIEW

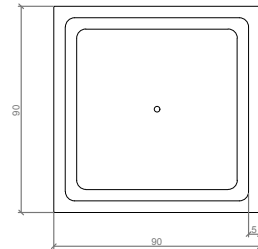

PLANTA / TOP VIEW

ESC. 1:20

ESPECIFICACIONES / SPECIFICATIONS

Casquillo M12 - tubo acero zincado alta precisión
 Tube M12 - galvanized steel pipe high precision

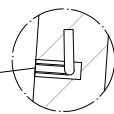

DETALLE B-B' / DETAIL B-B'

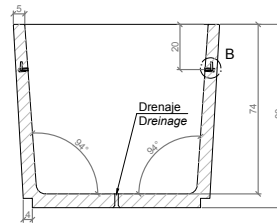

SECCIÓN A-A' / SECTION A-A'

MANIPULACIÓN E INSTALACIÓN / HANDLING AND INSTALLATION

1 Enroskar cáncamo, fijar eslingas e instalar / Thread the eyebolt, fixing slings and install.

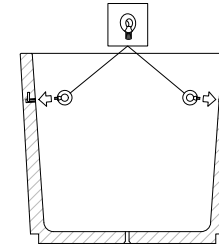

SOLO PARA DESCARGAR DEL PALET
 ONLY TO UNLOAD THE PALLET

Elevación / Hoisting
 P= 400 Kg

