

**CARACTERÍSTICAS / FEATURES**

**Material** hormigón petra2  
**Acabado** decapado  
**Dimensiones** Ø55, h. 110 cm.  
**Color** ver carta de colores  
**Fijación** simplemente apoyado o mediante varillas metálicas  
**Peso / Capacidad:** 119 Kg / 70 L  
**Bulto** 120 x 110 x 125 cm [ 4u / bulto ]  
**Peso bulto** 495 Kg

**Material** precast concrete petra2  
**Finish** scaled  
**Dimensions** Ø55, h. 110 cm.  
**Colour** see colour catalogue  
**Fixing** resting on the ground & or anchored with metal rod  
**Weight / Capacity** 119 Kg / 70 L  
**Package** 120 x 110 x 120 cm [ 4u / bulto ]  
**Weight package** 495 Kg

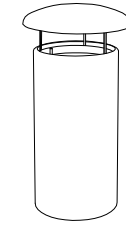

**GEOMETRIA / GEOMETRY**

**SET / CONJUNTO**

**ACCESORIO / ACCESSORIES**

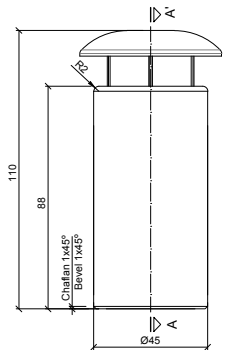

ALZADO / FRONT VIEW

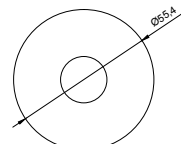

PLANTA / TOP VIEW

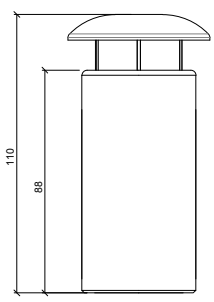

PERFIL / PROFIL VIEW

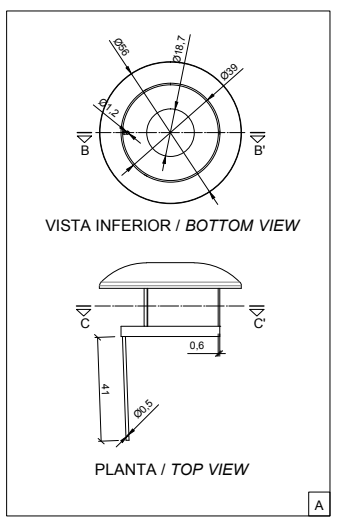

VISTA INFERIOR / BOTTOM VIEW

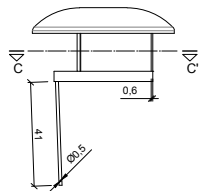

PLANTA / TOP VIEW

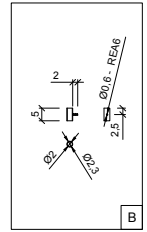

B

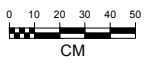

CM

**ESPECIFICACIONES / SPECIFICATIONS**

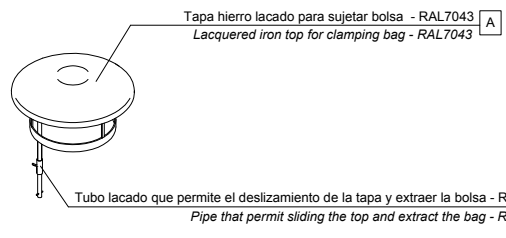

DETALLE ACCESORIO / DETAIL ACCESSORIES

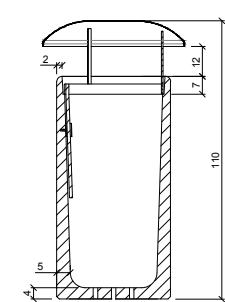

SECCIÓN A-A' / SECTION A-A'

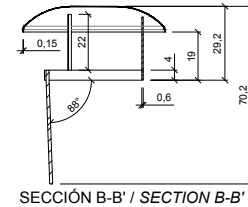

SECCIÓN B-B' / SECTION B-B'

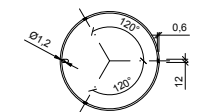

SECCIÓN C-C' / SECTION C-C'

**MANIPULACIÓN E INSTALACIÓN / HANDLING AND INSTALLATION**

1 Perforar agujero y verter resina epoxy dentro / Drill hole and pour resin epoxy inside hole

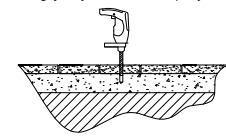

2 Posicionar la varilla en el agujero central y fijar con tuercas hexagonales / Place the threaded rod into the center hole and fix with nut hexagonal

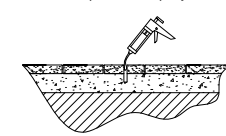
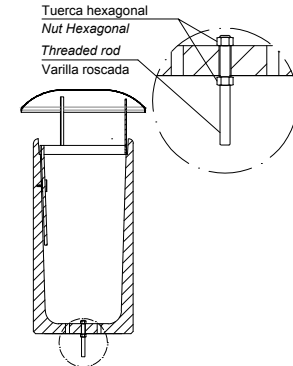

3 Insertar varilla roscada en agujero / Insert metal threaded rod in hole

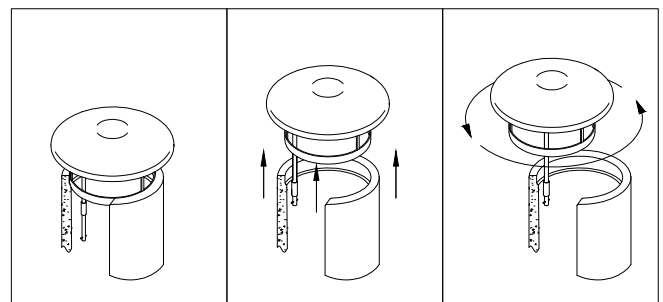
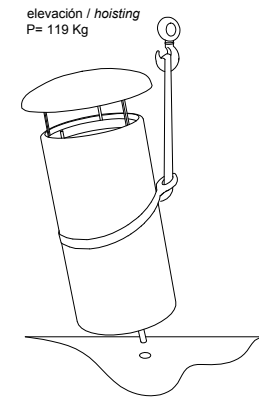

DETALLE DE EXTRACCIÓN BOLSA / DETAIL OF HOW EXTRACT BAG